



Moroccan Style™

The Leisure Pools Moroccan Style incorporates the best features of previous Leisure Pools with exciting new ideas. The rectangle pool has been in use for over 3000 years and remains the most efficient and beautiful pool design. The Moroccan Style builds on this flawless design with a range of innovative features to enhance usability and beauty in your backyard.

Criteria	Length	Width	Deep End	Shallow End	Gallons
Moroccan 38	38' 4"	15'	6' 2"	3' 8"	19,800
Moroccan 34	34' 2"	15'	5' 11"	3' 8"	17,100
Moroccan 31	30' 10"	15'	5' 8"	3' 8"	15,000
Moroccan 27	27'	14'	5' 3"	3' 8"	11,600

Instead of just one entry point, the Moroccan Style features three points of entry - one at the shallow end, one on the opposite side at the deep end and a third at the center of the pool. This means that however you place your pool in relation to your house or pool side area, you will be assured of an entry/exit point adjacent to it.

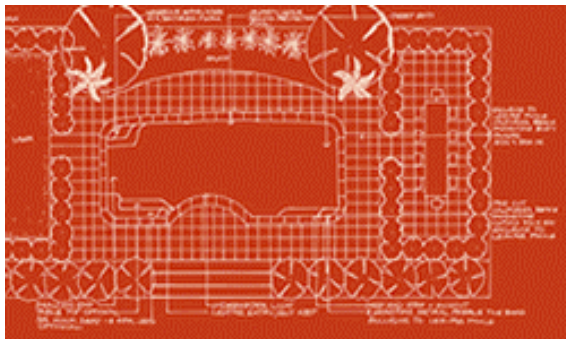

The Moroccan Style has excellent seating areas with a swim out and step at the deep end.

It also has generous seating areas at the shallow end, where optional spa jets can be installed. There is even provision for an optional in-pool table.

The clever design of the Moroccan Style also provides a wide, unobstructed corridor through the center of the pool for unrestricted end to end swimming.

The Moroccan Style also features a cleverly engineered ultra narrow coping that results in a more spacious pool for its outside dimensions. The Moroccan comes in four sizes to accommodate all backyards and budgets.

Here are the Moroccan Style pool design philosophies from its designer, Kerry Pain.

- Excellence in Design – Since its inception a short time ago, the Moroccan has become the most popular family pool on the market today. This generously sized pool comes in 4 sizes to suit almost every site.
- A Step Ahead – The Moroccan features three conveniently located entry/exit points. This means you can situate the Moroccan almost any way in relation to your house and you will still have steps in a convenient place.
- Swim or Relax – The Moroccan is designed for both! The swimming corridor is unobstructed for end to end swimming and when you've had enough exercise you can relax in the spa nook. You can even have an in-pool table built into the spa nook.
- Safety – With three entry/exit points, a swim out seat at the deep end and Leisure Pools safety convenience around the perimeter of the pool, The Moroccan takes away a lot of the worries for new swimmers. Remember the spa seat is a great place to sit and watch the kids.

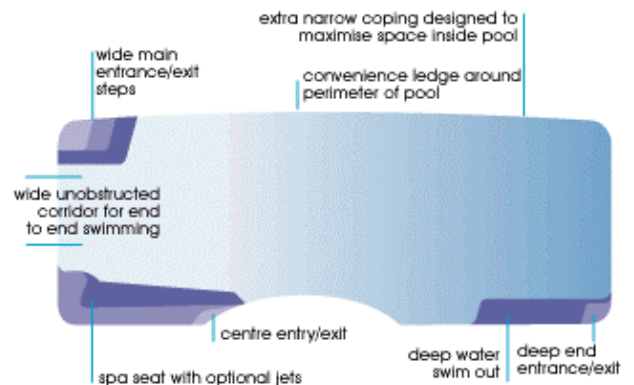

www.leisurepoolsusa.com

©Copyrighted Leisure Pools 2007

All Rights Reserved

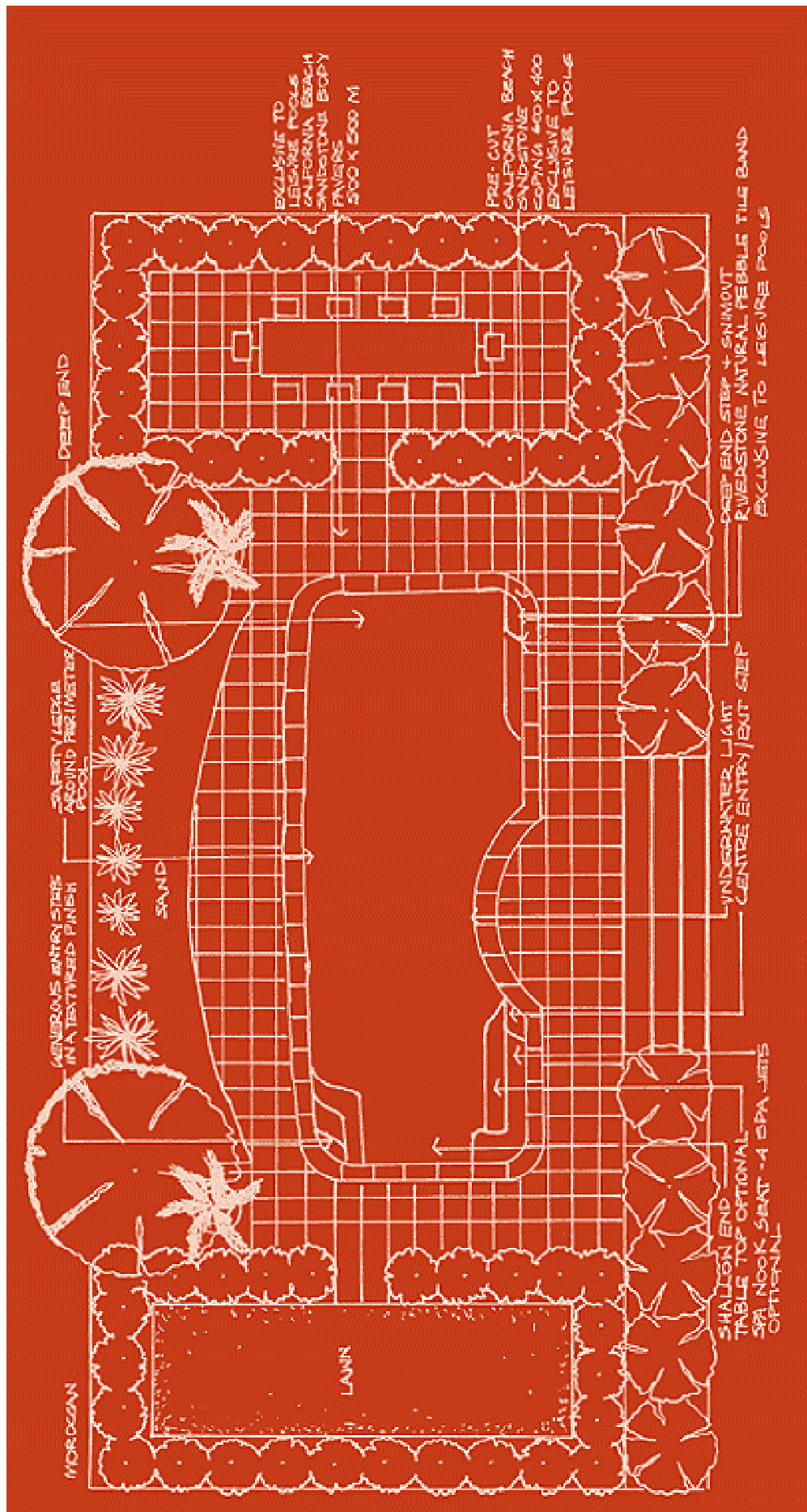

www.leisurepoolsusa.com

©Copyrighted Leisure Pools 2007
All Rights Reserved